

Consulting Engineers Certification

I, Mitchell GASSMAN, hereby certify that the As Constructed information shown on this plan is a true and correct record of the sizes, types, materials, classes etc., and it corresponds with the relevant approved Engineering Drawings.

Signed: [Signature] RPEQ No 16939 Dated: 21/11/2023

Registered Surveyor's Certification

I, Anthony GERAGHTY, hereby certify that the horizontal and vertical locations, and dimensions shown on this plan are a true and correct record of the As Constructed information.

Signed: [Signature] Reg. No 3222 Dated: 21/11/2023

# PRELIMINARY

## FEATURE LEGEND

- MANHOLE
- GULLY PIT
- DRAINWAY
- FIELD INLET
- HEADWALL
- BLANKED OFF END STORMWATER PIPE
- EXISTING MANHOLE
- EXISTING HEADWALL
- EXISTING GULLY PIT
- EXISTING DRAINWAY
- EXISTING STORMWATER PIPE

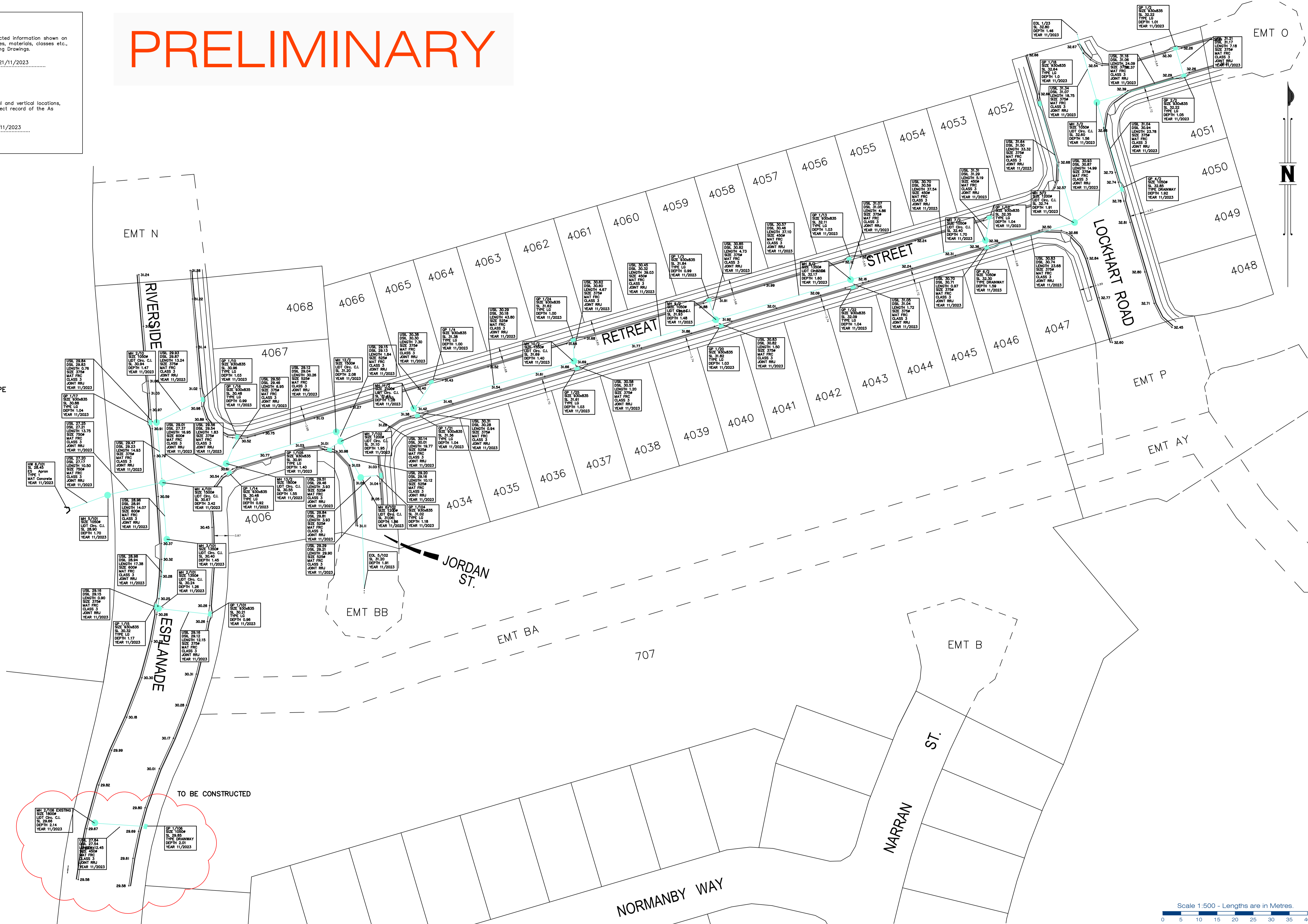

Scale 1:500 - Lengths are in Metres.  
0 5 10 15 20 25 30 35 40



gassman development perspectives  
est 1985  
planning | environment | landscape | engineering | survey  
T: 3807 3333 | F: 3287 5461 | www.gassman.com.au  
Gold Coast | 76 Business Street, Yatala QLD | PO Box 392, Beenleigh 4207

Issue	Date	Description	SH	TH	CHK
-	30-11-2023	ORIGINAL ISSUE			

Project: **RIVERTON**  
Cusack Lane, Jimboomba

Client: **A.V.JENNINGS**

©2012 Gassman Development Perspectives  
All rights reserved. No part of this document may be reproduced or transmitted in any form or by any means, electronic, mechanical, photocopying, recording, or otherwise, without the written permission of Gassman Development Perspectives.

Scale at A1: **1:500**  
Date: **30-11-23**  
Surveyed: **TH**  
Drawn: **SH**  
Checked: **TH**

Drawing Title: **AS CONSTRUCTED PLAN STAGE 4A STORMWATER**

Drawing No: **5544 500 STG 4A - STORMWATER** Revision No:

Consulting Engineer's Certification  
 I, Mitchell GASSMAN, hereby certify that the As Constructed information shown on this plan is a true and correct record of the sizes, types, materials, classes etc., and it corresponds with the relevant approved Engineering Drawings.  
 Signed..... RPEQ No 16939 Dated..... 22/12/2023

Registered Surveyor's Certification  
 I, Anthony GERAGHTY, hereby certify that the horizontal and vertical locations, and dimensions shown on this plan are a true and correct record of the As Constructed information.  
 Signed..... Reg. No 3222 Dated..... 22/12/2023

- FEATURE LEGEND**
- MANHOLE
  - GULLY PIT
  - DRAINWAY
  - FIELD INLET
  - HEADWALL
  - BLANKED OFF END
  - STORMWATER PIPE
  - EXISTING MANHOLE
  - EXISTING HEADWALL
  - EXISTING GULLY PIT
  - EXISTING DRAINWAY
  - EXISTING STORMWATER PIPE



Issue	Date	Description	TG/P	TH
-	22-12-2023	ORIGINAL ISSUE	TG/P	TH

Project: **RIVERTON**  
 Cusack Lane , Jimboomba

Client: **A.V.JENNINGS**

©2012 Gassman Development Perspectives  
 All rights reserved. No part of this document may be reproduced or transmitted in any form or by any means, electronic, mechanical, photocopying, recording, or otherwise, without the written permission of Gassman Development Perspectives.

Scale at A1: **1:500**

Date: **22-12-23**

Surveyed: **TH**

Drawn: **TGP**

Checked: **TH**

Drawing Title:  
**AS CONSTRUCTED PLAN  
 STAGE 4Aii STORMWATER**

Drawing No: **5544 500 STG 4Aii - STORMWATER**

Revision No: