

Consulting Engineer's Certification
 I, Mitchell GASSMAN, hereby certify that the As Constructed information shown on this plan is a true and correct record of the sizes, types, materials, classes etc., and it corresponds with the relevant approved Engineering Drawings.
 Signed..... RPEQ No 16939 Dated..... 05/12/2023

Registered Surveyor's Certification
 I, Anthony GERAGHTY, hereby certify that the horizontal and vertical locations, and dimensions shown on this plan are a true and correct record of the As Constructed information.
 Signed..... Reg. No 3222 Dated..... 05/12/2023

NOTES
 ALL WATERMAINS 100# uPVC-m PN16 u.n.o.
 ALL WATERMAINS ROAD CROSSINGS 100# DICL CLASS 9
 0.9m COVER UNDER ROAD

FEATURE LEGEND

- WATER FIRE HYDRANT
- T WATER TEE
- X WATER SLUICE VALVE
- WATER BEND
- WATER ENDCAP
- WATER PIPE
- WATER DICL
- WATER CONDUIT
- > REDUCER
- EXISTING WATER PIPE
- EXISTING WATER DICL
- EXISTING WATER FIRE HYDRANT
- T EXISTING WATER TEE
- X EXISTING WATER SLUICE VALVE
- EXISTING WATER BEND
- Δ EXISTING WATER READY TAP

WATERMAIN FITTINGS

No.	ITEM
1	100# Sluice Valve
2	100#x100 Hydrant
3	100x100# Tee
4	100#x11.25" Bend
5	100#x22.5" Bend
6	100#x45" Bend
7	100#x90" Bend
8	100# Endcap
9	150# Sluice Valve
10	150#x150 Hydrant
11	150x100# Tee
12	150#x11.25" Bend
13	150#x22.5" Bend
14	150#x45" Bend
15	150#x90" Bend
16	150# Endcap
17	200# Sluice Valve
18	200#x200 Hydrant
19	200x100# Tee
20	200#x6" Bend
21	200#x11.25" Bend
22	200#x22.5" Bend
23	200#x45" Bend
24	200#x90" Bend
25	200# Endcap
26	200# to 150# Reducer

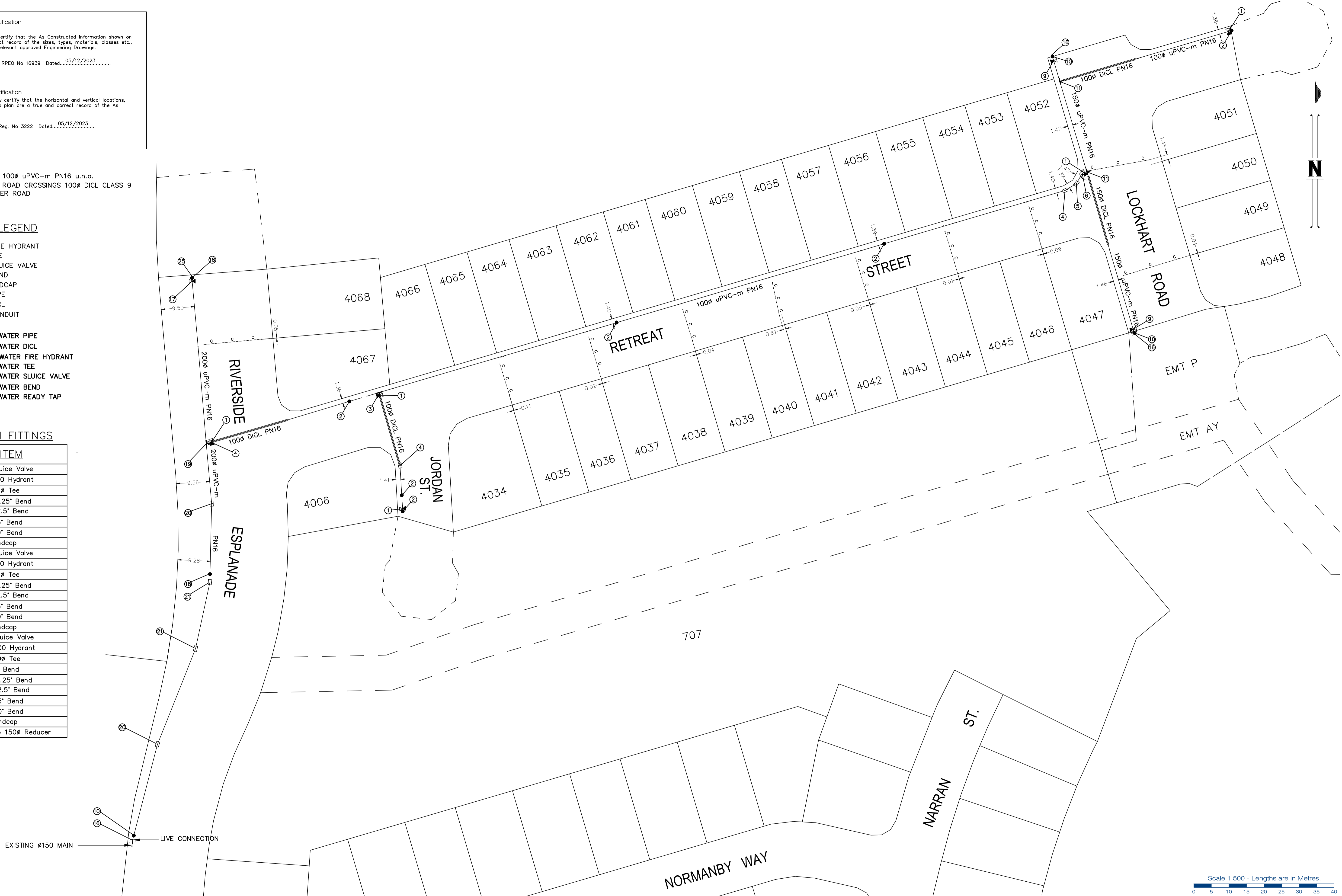

Issue	Date	Description	SH	TH	DRN	CHK
-	05-12-2023	ORIGINAL ISSUE				

Project: RIVERTON
 Cusack Lane , Jimboomba

Client: A.V.JENNINGS

©2012 Gassman Development Perspectives
 All rights reserved. No part of this document may be reproduced or transmitted in any form or by any means, electronic, mechanical, photocopying, recording, or otherwise, without the written permission of Gassman Development Perspectives.

Scale at A1: 1:500
 Date: 06-12-23
 Surveyed: TH
 Drawn: SH
 Checked: TH

Drawing Title:
 AS CONSTRUCTED PLAN
 SUBMISSION 2
 STAGE 4A WATER

Drawing No: 5544 500 STG 4A SUBMISSION 2 - WATER
 Revision No:

Consulting Engineer's Certification
 I, Mitchell GASSMAN, hereby certify that the As Constructed information shown on this plan is a true and correct record of the sizes, types, materials, classes etc., and it corresponds with the relevant approved Engineering Drawings.
 Signed: [Signature] RPEQ No 16939 Dated: 22/12/2023

Registered Surveyor's Certification
 I, Anthony GERAGHTY, hereby certify that the horizontal and vertical locations, and dimensions shown on this plan are a true and correct record of the As Constructed information.
 Signed: [Signature] Reg. No 3222 Dated: 22/12/2023

NOTES
 ALL WATERMAINS 100Ø uPVC-m PN16 u.n.o.
 ALL WATERMAINS ROAD CROSSINGS 100Ø DICL CLASS 9
 0.9m COVER UNDER ROAD

FEATURE LEGEND

- WATER FIRE HYDRANT
- T WATER TEE
- X WATER SLUICE VALVE
- WATER BEND
- WATER ENDCAP
- WATER PIPE
- WATER DICL
- WATER CONDUIT
- > REDUCER
- EXISTING WATER PIPE
- EXISTING WATER DICL
- EXISTING WATER FIRE HYDRANT
- T EXISTING WATER TEE
- X EXISTING WATER SLUICE VALVE
- EXISTING WATER BEND
- Δ EXISTING WATER READY TAP

WATERMAIN FITTINGS

No.	ITEM
1	100Ø Sluice Valve
2	100Øx100 Hydrant
3	100x100Ø Tee
4	100Øx11.25" Bend
5	100Øx22.5" Bend
6	100Øx45" Bend
7	100Øx90" Bend
8	100Ø Endcap
9	100Øx16" Bend



Scale 1:500 - Lengths are in Metres.
 0 5 10 15 20 25 30 35 40



Issue	Date	Description	DRN	CHK
-	22-12-2023	ORIGINAL ISSUE	TGP	TH

Project: **RIVERTON**
 Cusack Lane , Jimboomba

Client: **A.V.JENNINGS**

©2012 Gassman Development Perspectives
 All rights reserved. No part of this document may be reproduced or transmitted in any form or by any means, electronic, mechanical, photocopying, recording, or otherwise, without the written permission of Gassman Development Perspectives.

Scale at A1: **1:500**
 Date: **22-12-23**
 Surveyed: **TH**
 Drawn: **TGP**
 Checked: **TH**

Drawing Title:
**AS CONSTRUCTED PLAN
 STAGE 4Aii WATER**

Drawing No: **5544 500 STG 4Aii - WATER** Revision No: